

Mount Claret Center is a sacred place nestled in the foothills of Camelback Mountain, whose mission is to provide a tranquil environment and opportunities to develop and renew inner life.

Located in Phoenix, on 54th Street, just north of Camelback Road, the Center is centrally accessible to all parts of the "Valley of the Sun". The beautiful desert landscape, of ten acres, is framed by the majestic mountains and blue sky. This awesome sight immediately beckons its visitors into a new world of peace and serenity to enhance the precious time spent in prayer, reflection, and renewal.

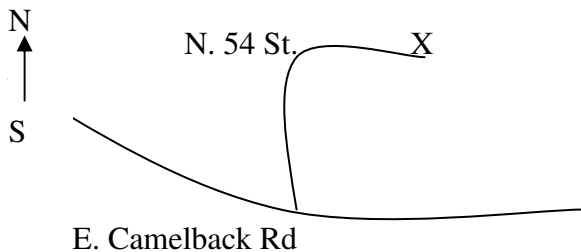

4633 N 54th St, Phoenix, AZ

- Space is limited so reserve your spot by pre-registering

Scholarships

Half Scholarships may be available contact:

Yvonne Evans
623-486-4866
✉ pea2ed@cox.net

Accommodations, Etc.

- ✓ Coffee, soda, bottled water is available for purchase throughout the weekend
- ✓ Facility is handicapped accessible
- ✓ Chairs in meeting room are not padded – bring a pillow/cushion
- ✓ Men & women have separate sleep facilities
- ✓ Schedules will be available at check-in
- ✓ Bring money for the '50/50' and other fun events
- ✓ Sleeping quarters are dormitory style. We do not have accommodations for couples
- ✓ Bring your own bedding, pillows, towels, and soap etc.
- ✓ Green friendly bring your own coffee cup

ASDI ANNUAL OVEREATERS ANONYMOUS WINTER RETREAT

"Sail Away with OA"

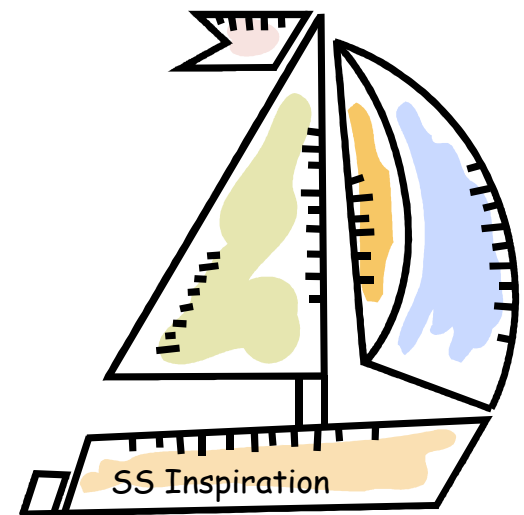

Winter Retreat 2010
January 22, 23, & 24
Mt. Claret

4633 N 54th St
Phoenix, AZ 85018-1904

Payable to ASDI to:
Kaye White
400 N. Plaza Drive #644
Apache Junction AZ 85120-5506
480-321-6008

Name: _____

Phone:() _____

Email: _____

Address: _____

Female() Male()

If handicapped what are your needs?

\$ _____ Option 1: Spend Weekend +4 meals
\$149.00 Early bird special before Nov. 25

\$ _____ Option 2: No overnights + 4 meals \$99.00
– Early bird special before Nov. 25

AFTER November 25, 2009

\$ _____ Option 1: Spend weekend +4 meals
\$169.00

\$ _____ Options 2: No overnights + 4 meals
\$119.00

\$ _____ Donation to ASDI for Retreat scholarship
fund (optional)

\$ _____ Total Enclosed

_____ Interested in Half-Scholarship & you are
encouraged to volunteer to do service at
the retreat.

Non-refundable \$50.00 for either options if
unable to attend event.



I put my hand in yours and together we can
do what we could never do alone.
No longer is there a sense of hopelessness.
No longer must we each depend on our own
unsteady willpower. We are all together
now, reaching out our hands for power and
strength greater than our own. And as we
join hands, we find love and understanding
beyond our wildest dreams!

Winter Retreat 2010 January 22, 23, & 24

- (1) Complete section to the left
- (2) Please make a copy for you to keep
- (3) Detach
- (4) Mail it with your check

Payable to ASDI to:
Kaye White
400 N. Plaza Drive #644
Apache Junction AZ 85120-5506
480-321-6008

**PLEASE REGISTER EARLY
SPACE IS LIMITED**

Cost

Early Bird Special *when received by
November 25, 2009*

Option 1: \$149.00 per person – Includes
event, 4 meals*, 2 nights' lodging and added
fellowship!

Option 2: \$99.00 per person – Includes event
and 4 meals* (No overnight stay)

***Meals included:** Saturday breakfast, lunch, and
dinner; and Sunday breakfast. You can brown bag
Friday night dinner and enjoy fellowship with others.

Cost after November 25, 2009

Option 1: \$169.00 per person (as above)

Option 2: \$119.00 per person (as above)

Note: For either option...**To receive the Early
Bird rate, your non-refundable** deposit of
\$50 must be received by Nov. 25, 2009

Final payments are due by
December 15, 2009

"Half Scholarships may be available. If
interested please contact:

Yvonne
623-486-4866